

**DRAFT PLAN OF SUBDIVISION
MAITLAND COMMONS**

PART OF LOT 3, CONCESSION 3
(FORMERLY THURLOW TOWNSHIP)
NOW IN
THE CITY OF BELLEVILLE
COUNTY OF HASTINGS

SCALE 1:500

METRIC NOTE:
DISTANCES SHOWN ON THIS PLAN ARE IN METRES AND CAN BE
CONVERTED TO FEET BY DIVIDING BY 0.3048.

CONTOUR NOTE:
CONTOUR AND TOPOGRAPHIC INFORMATION GENERATED USING
INFORMATION PROVIDED BY ONTARIO BASE MAPPING.

NO. REVISION DATE APPROVED
DRAWN BY: LB CHECKED BY: R.F.A. DATE: 09/30/20

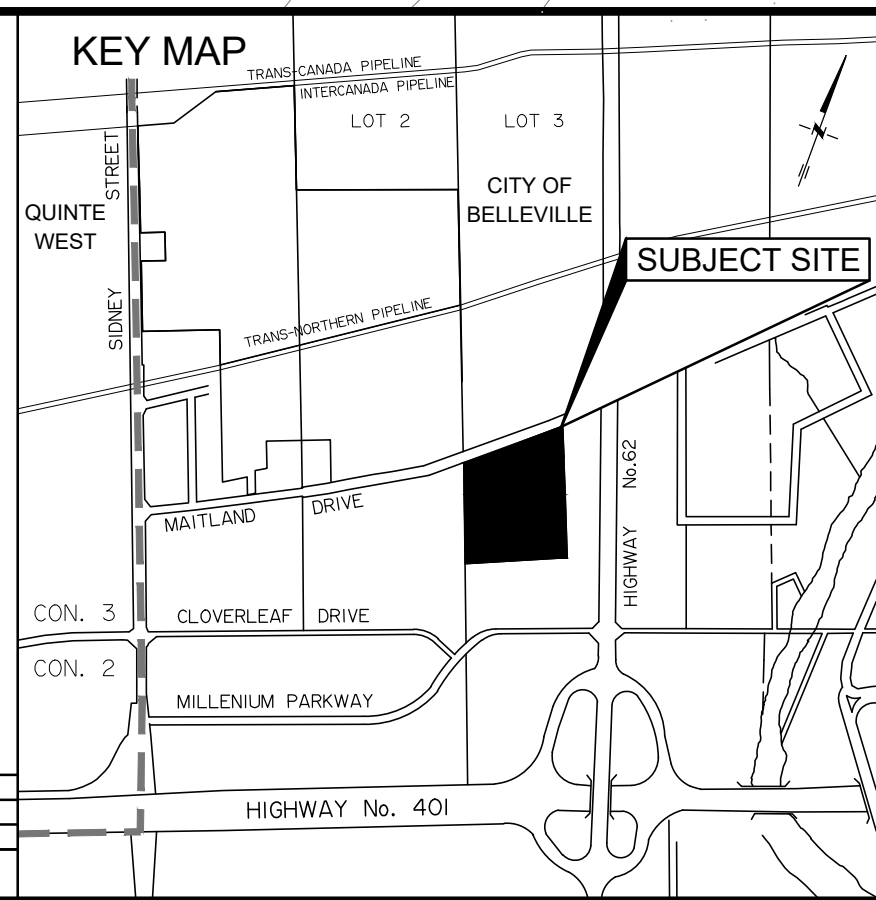

LAND USE SCHEDULE

LAND USE	AREA(m ²)	AREA%	UNITS
LOTS 1-6 & 15-32 - 12.8m (423.6m ²) MIN. SINGLE-DETACHED LOTS	11929.5	24.7	24
LOTS 7-14 & 33-36 - 13.7m (472.4m ²) MIN. SINGLE-DETACHED LOTS	7465.0	15.4	12
BLOCKS 37-41 - 6.1m (240.0m ²) MIN. 2 STOREY TOWNHOUSES	7119.9	14.7	23
BLOCK 42 - BACK TO BACK, 2 STOREY TOWNHOUSES	7285.2	15.1	38
BLOCK 43 - STORM WATER FACILITY	2739.0	5.7	
BLOCK 44 - 5.0m SERVICE EASEMENT/WALKWAY (TO BE DEEDED TO MUNICIPALITY)	166.8	0.3	
BLOCK 45 - EXISTING SERVICE EASEMENT (TO BE DEEDED TO MUNICIPALITY)	2008.0	4.1	
BLOCKS 46, 47 & 48 - 0.3m RESERVES	40.0	0.0	
20.0m MUNICIPAL ROAD ALLOWANCE STREET 'A' (LENGTH = 450.0m)	9635.8	20.0	
SITE TOTAL	48389.2m²	100.0%	97

**ADDITIONAL INFORMATION REQUIRED
UNDER SECTION 51(17) OF THE
PLANNING ACT.**

(a) SEE SURVEYORS CERTIFICATE.
(b) AS SHOWN ON DRAFT PLAN.
(c) AS SHOWN ON DRAFT PLAN.
(d) SEE LAND USE SUMMARY
(e) SEE DRAFT PLAN
(f) AS SHOWN ON DRAFT PLAN.
(g) AS SHOWN ON DRAFT PLAN.
(h) MUNICIPAL WATER AND SANITARY SEWER
(i) GLACIAL TILL
(j) AS SHOWN ON DRAFT PLAN.
(k) GARBAGE COLLECTION, FIRE PROTECTION, ROAD MAINTENANCE,
SCHOOL BUSES, ETC.
(l) AS SHOWN ON DRAFT PLAN.

PLAN COPYRIGHT
ALL ORIGINAL DRAWINGS AND RELATED DOCUMENTS ARE THE
COPYRIGHT PROPERTY OF RFA PLANNING CONSULTANT INC.
REPRODUCTION IN WHOLE OR IN PART IS FORBIDDEN WITHOUT
THE WRITTEN CONSENT OF RFA PLANNING CONSULTANT INC.

THESE DRAWINGS AND DOCUMENTS MAY NOT BE USED FOR ANY
PURPOSES OTHER THAN FOR THE PROJECT FOR WHICH THEY ARE
PREPARED. THE PLAN IS NOT AVAILABLE TO THIRD PARTY WITHOUT
THE WRITTEN CONSENT OF RFA PLANNING CONSULTANT INC.

SURVEYOR'S CERTIFICATE
I CERTIFY THAT THE BOUNDARIES OF THE LAND TO BE
SUBDIVIDED ARE CORRECTLY SHOWN.

Keith Watson Sept. 30/20
KEITH WATSON, ONTARIO LAND SURVEYOR. DATE

WATSON LAND SURVEYORS LTD.
218 CHURCH STREET, BELLEVILLE, ONTARIO
(613) 962-9521

RFA PLANNING CONSULTANT INC.

690-DP

211 Dundas Street East, Suite 202,
Belleville, Ontario, K8N 1E2