

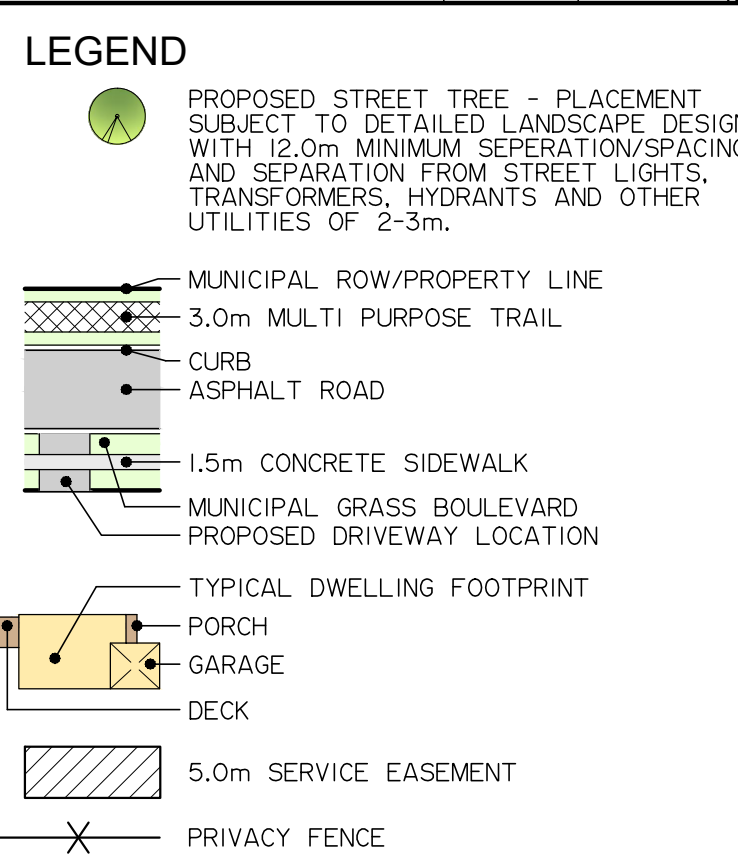

DWELLING TYPE ZONING BY-LAW No. 10245	SINGLE DETACHED DWELLING		SEMI-DETACHED DWELLING		TOWNHOUSE DWELLING MULTI-STORY		TOWNHOUSE DWELLING SINGLE-STORY	
	R3-X ZONE	ON PLAN	R3-X ZONE	ON PLAN	R3-X ZONE	ON PLAN	R3-X ZONE	ON PLAN
MINIMUM LOT FRONTAGE: - INTERIOR LOT	12.2m	12.2m	8.7m	8.7m	6.0m	6.1m	7.3m	7.3m
- CORNER LOT	14.6m	14.6m	11.1m	11.9m	9.7m	9.7m	11.1m	13.0m
LOT AREA (MINIMUM)	390.0m ²	420.8m ²	290.0m ²	290.3m ²	200.0m ²	200.0m ²	250.0m ²	253.3m ²
FRONT YARD DEPTH (MINIMUM)	6.0m	6.0m	6.0m	6.0m	6.0m	6.0m	6.0m	6.0m
INTERIOR SIDE YARD (MINIMUM)	1.2m	1.2m	1.2m	1.2m	1.2m	1.2m	1.2m	1.2m
- SEE YARD IS ADJACENT TO A COMMON WALL	N/A	N/A	0.0m	0.0m	0.0m	0.0m	0.0m	0.0m
EXTERIOR SIDE YARD (MINIMUM)	3.6m	3.6m	3.6m	3.6m	3.6m	3.6m	3.6m	4.5m
REAR YARD (MINIMUM)	7.0m	7.5m	7.0m	7.0m	7.0m	7.0m	7.0m	10.2m
LOT COVERAGE (MAXIMUM)	45.0%	42.0%	45.0%	45.0%	55.0%	55.0%	55.0%	51.0%
BUILDING HEIGHT (MAXIMUM) MAIN BUILDING	11.0m	11.0m	11.0m	11.0m	11.0m	11.0m	11.0m	11.0m

LAND USE	AREA(m ²)	AREA%	UNITS
LOTS 1-4, 16-20 & 29-32 -15.0m (510.0m ²) MIN. - SINGLE-DETACHED LOTS	9659.7	30.3	13
LOTS 5-8, 15 & 33-35 -13.7m (466.3m ²) MIN. - SINGLE-DETACHED LOTS	4010.2	12.6	8
LOTS 9-14 & 21-28 -12.2m (420.8m ²) MIN. - SINGLE-DETACHED LOTS	7043.8	22.1	14
BLOCKS 36 & 37 - 7.3m (253.3m ²) MIN. - FREEHOLD BUNGALOW TOWNHOUSE UNITS	2969.9	9.3	9
20.0m MUNICIPAL ROAD ALLOWANCE & RESERVES - STREETS 'A' AND HASTINGS PARK DRIVE EXTENSION (LENGTH = 366.6m)	8168.6	25.7	
SITE TOTAL	31852.2m²	100.0%	44



PLAN COPYRIGHT
ALL ORIGINAL DRAWINGS AND RELATED DOCUMENTS ARE THE COPYRIGHT PROPERTY OF RFA PLANNING CONSULTANT INC. REPRODUCTION IN WHOLE OR IN PART IS FORBIDDEN WITHOUT THE PRIOR WRITTEN CONSENT OF RFA PLANNING CONSULTANT INC.

THESE DRAWINGS AND DOCUMENTS MAY NOT BE USED FOR ANY PURPOSES OTHER THAN FOR THE PROJECT FOR WHICH THEY ARE PREPARED. THE PLAN IS NOT AVAILABLE TO THIRD PARTY WITHOUT THE WRITTEN CONSENT OF RFA PLANNING CONSULTANT INC.

METRIC NOTE:
DISTANCES SHOWN ON THIS PLAN ARE IN METRES AND CAN BE CONVERTED TO FEET BY DIVIDING BY 0.3048.

DEVELOPMENT SITE PLAN
AMENDED DRAFT APPROVED
PLAN OF SUBDIVISION 12T-06501

POTTERS CREEK - PHASE 9B
PART OF PARTS 1, 3 & 4, PLAN 21R-23362
PART 1, 21R-26038
PART OF LOTS 32 & 33
CONCESSION 1

GEOGRAPHIC TOWNSHIP OF SIDNEY,
NOW IN THE
CITY OF BELLEVILLE,
COUNTY OF HASTINGS

SCALE 1:500

1 ORIGINAL DRAFT PLAN SUBMISSION TO CITY OF BELLEVILLE APRIL 06/12 R.F.A.
2 REVISIONS DATE 09/10

DRAWN BY: LB CHECKED BY: R.F.A. DATE: 11/15/22

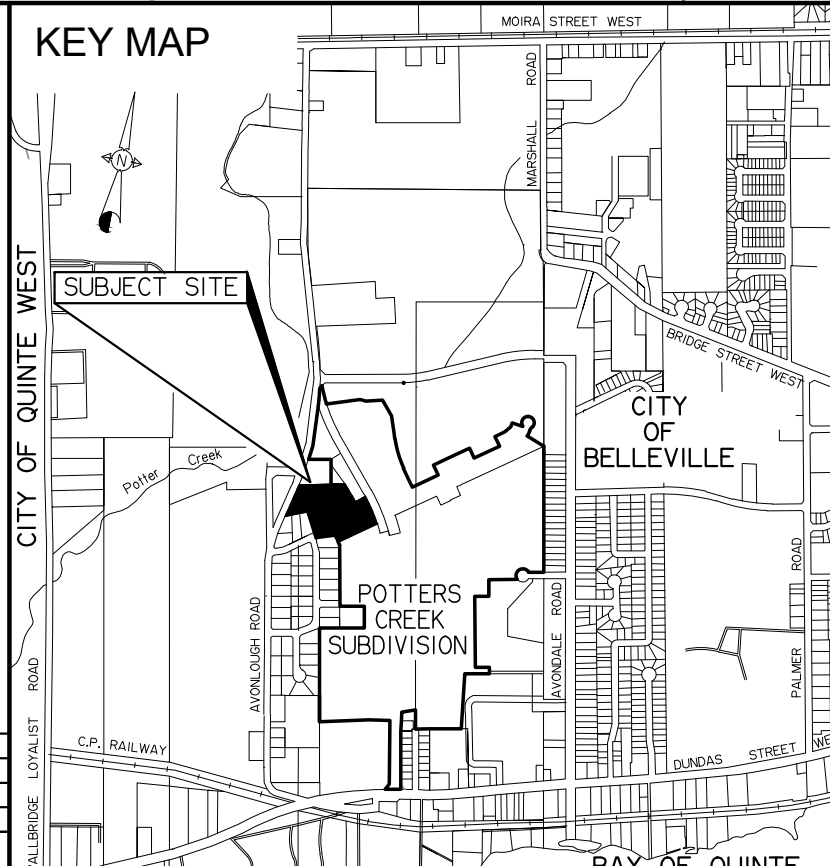

244-DSP 9B

211 Dundas Street East, Suite 202,
Belleville, Ontario, K8H 1Z2