

HASTINGS PRINCE EDWARD DISTRICT SCHOOL BOARD EAST HILL ELEMENTARY SCHOOL SANITARY SERVICE REPLACEMENT

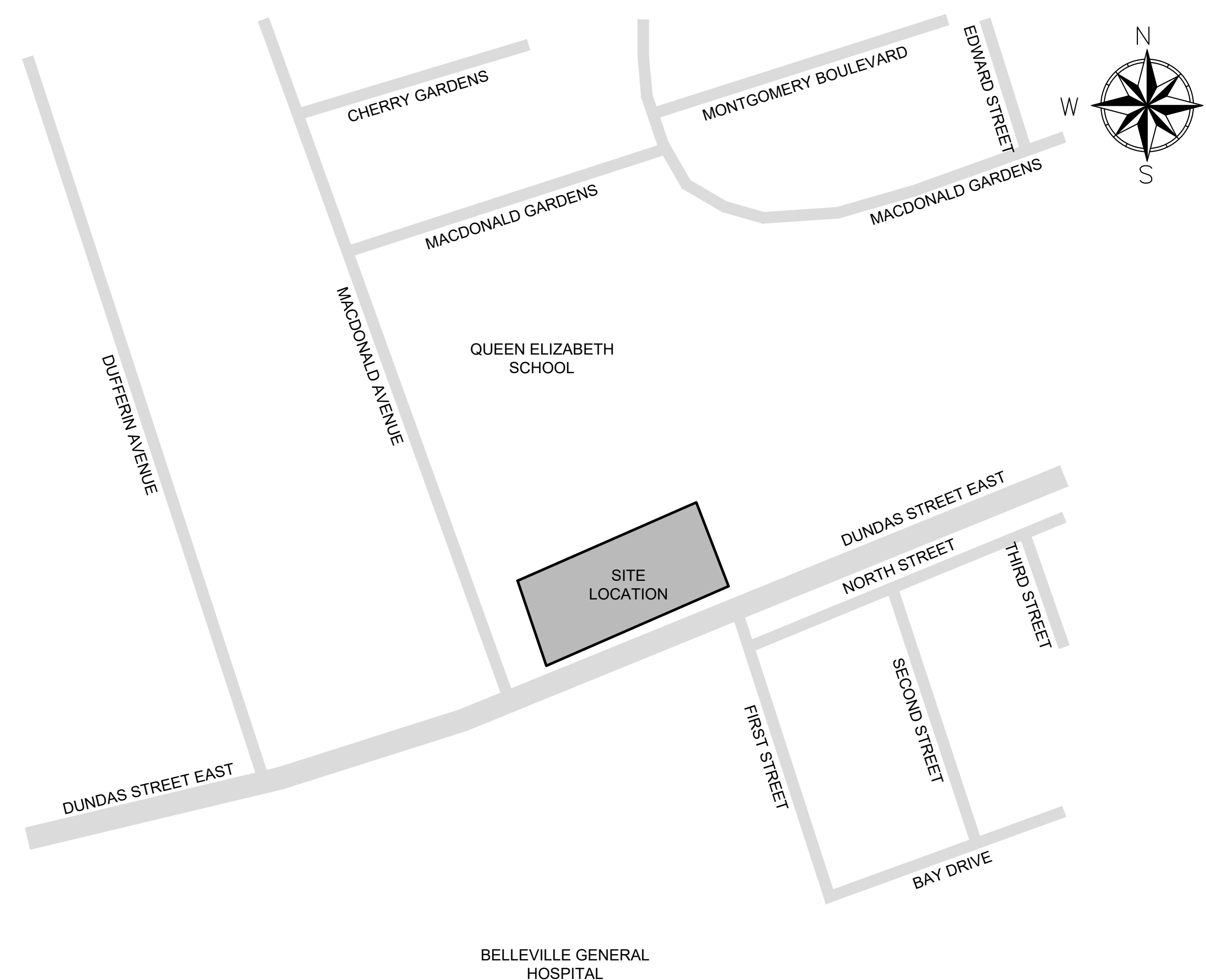

TITLE	DRAWING NUMBER
PLAN AND PROFILE	PP-1
DETAILS AND NOTES	DE-1

NOTE:

REFER TO OLS DRAWING FOR EASEMENT LOCATION
INSULATE ACCORDING TO OPSD 1109.030
WHERE COVER LESS THAN 1.5m

STRUCTURE	NORTHING	EASTING
SA1	4892853.982	310943.199
SA2	4892854.898	310948.664

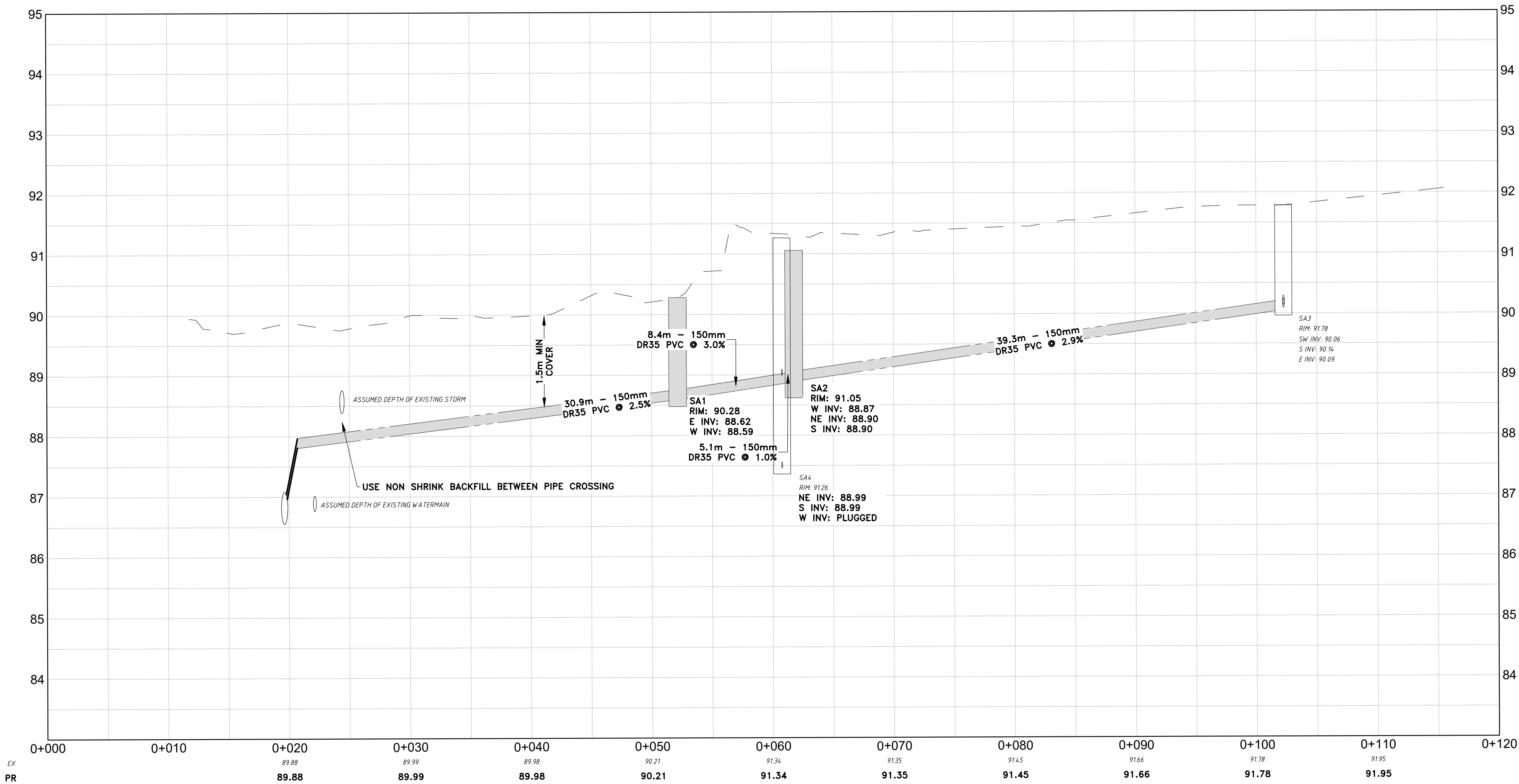

GENERAL NOTES:
- ALL INFORMATION TO BE VERIFIED ON SITE PRIOR TO COMMENCING ANY WORK. ANY DISCREPANCIES ARE TO BE REPORTED TO THE CONSULTANT IMMEDIATELY.
- ALL UTILITY LOCATIONS SHOWN ON THE DRAWINGS ARE APPROXIMATE. THE CONTRACTOR SHALL CONFIRM THE LOCATION ON SITE AND ASSUME ALL LIABILITY FOR DAMAGE TO ALL UTILITIES.
- EXCLUDING THE BENCHMARK AND DESCRIPTION PROVIDED FOR THIS PROJECT, NO OTHER ELEVATIONS ARE TO BE USED AS A REFERENCE ELEVATION FOR ANY PURPOSE.

METRIC NOTE:
- ALL DIMENSIONS SHOWN ARE IN METRES OR MILLIMETRES, UNLESS OTHERWISE NOTED.

GEOMETRIC NOTE:
- ALL SURVEY DATA SHOWN ON THIS DRAWING WAS RECORDED USING REAL-TIME KINETIC (RTK) GPS OBSERVATIONS IN REFERENCE TO UTM 18 NORTH COORDINATE SYSTEM.
- ALL ELEVATIONS ARE IN REFERENCE TO LOCAL DATUM NAD83 - GEODETIC MODEL HTZ.0, UNLESS DESCRIBED OTHERWISE.

** DRAWINGS ARE NOT TO BE SCALED **

REVISIONS			
NO.	DATE	DESCRIPTION	BY
1	04/06/2025	ISSUED FOR REVIEW	DFM
2	31/07/2025	ISSUED FOR PERMIT	DFM

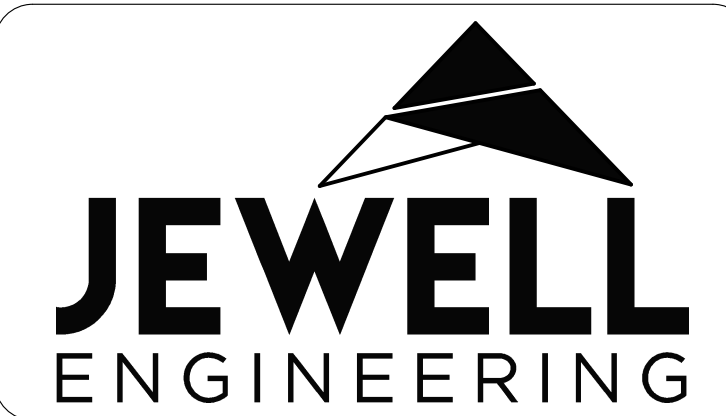
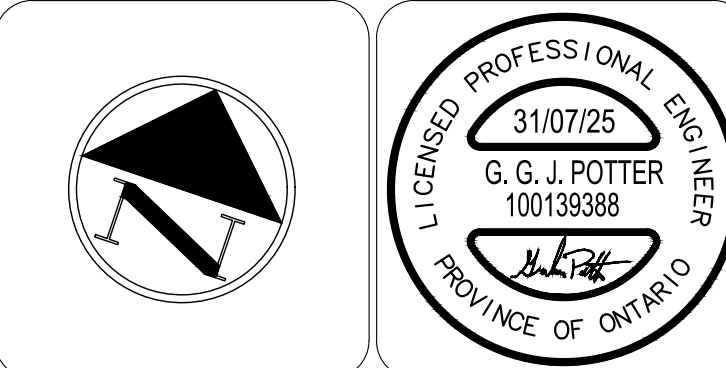

HASTINGS PRINCE EDWARD
COUNTY DISTRICT
SCHOOL BOARD
EAST HILL ELEMENTARY SCHOOL

PLAN AND PROFILE

DRAWN BY: ASG/DFM	PROJECT NO: 240-5726
DESIGNED BY: ASG/DFM	DATE: JUN 4, 2025
CHECKED BY: GP	SCALE: HORIZONTAL - 1:250 VERTICAL - 1:25
APPROVED BY: GP	CONTRACT NO: DRAWING NO: PP-1

CITY OF BELLEVILLE STANDARD NOTES

On-Site Notes (privately owned)

All sanitary sewer, storm sewer and watermain on private property is to be installed and tested in accordance with the Ontario Building Code.

The property is to be graded so that surface drainage is directed away from the buildings.

No blasting is permitted on City Road allowances or within the site.

General Notes Related To Off Site Works (road allowance)

Notwithstanding the following General Notes, underground and aboveground work is to be done in accordance with current City plans, standards and specifications including the following:

Rigid Pipe Bedding, Cover and Backfill Except a) Use "CLASS B - BEDDING" detail only for all pipe bedding; Delete "CLASS C - BEDDING" detail. b) The "granular bedding material" is to be Granular 'A' crushed material. c) "Cover material" is to be sand fill. d) Delete "150 mm" from "Note 1" and insert 225 mm for the minimum bedding depth. e) For a "wet trench" condition as determined by the City Engineer: the "granular bedding material" is to be an "HL8 Coarse" gradation, crushed limestone material, and the "cover material" is to be limestone screenings or Granular 'A' crushed material.	OPSD - 802.030
Precast Concrete Maintenance Hole, 1200 mm Diameter Except use precast monolithic base only.	OPSD - 701.010
Maintenance Hole Steps, Hollow Except delete "Rectangular Stainless Steel" step details.	OPSD - 405.010
Cast Iron, Square Frame with Circular Closed or Open Cover for Maintenance Holes Except delete "Type 'B' Open Cover".	OPSD - 401.010
Precast Concrete Catch Basin, 600 x 600 mm	OPSD - 705.010
Precast Concrete Twin Inlet Catch Basin, 600 x 1450 mm	OPSD - 705.020
Cast Iron, Square Frame With Square Overflow Type Dish Grate For Catch Basins, Herring Bone Openings	OPSD - 400.010
Precast Concrete Ditch Inlet, 600 x 600 mm	OPSD - 705.030
Galvanized Steel, Honey Comb Grating for Ditch Inlet	OPSD - 403.010
Catch Basin Connection for Rigid Main Pipe Sewer	OPSD - 708.010
Catch Basin Connection for Flexible Main Pipe Sewer	OPSD - 708.030
Cast-in-Place Maintenance Hole Drop Structure Tee Except the invert of the inlet end of the 90° bend is to be placed at the 'springline' of the main sewer pipe.	OPSD - 1003.010
Sewer Service Connections for Rigid Main Pipe Sewer Except a) The bedding and cover materials are to be supplied and installed in accordance with OPSD - 802.030, Rigid Pipe Bedding, Cover and Backfill, as revised by the City of Belleville. b) Factory made tees or wyes are not required for sanitary service connections to the main sewer pipe unless specified.	OPSD - 1006.010
Sewer Service Connections for Flexible Main Pipe Sewer Except a) The bedding and cover materials are to be supplied and installed in accordance with OPSD - 802.030, Rigid Pipe Bedding, Cover and Backfill, as revised by the City of Belleville. b) Factory made tees or wyes are not required for sanitary service connections to the main sewer pipe unless specified.	OPSD - 1006.020
Typical Connection into Storm Sewer over 450mm Dia. Standard Cleanout Detail	City Drawing Spec. M-15 City Drawing Spec. M-39

- (a) The Owner covenants and agrees not to make a material change or cause a material change to be made to a plan, specification, document or other information, on the basis of which these drawings were approved by the City, without notifying, filing details with and obtaining the written authorization of the City.
- (b) The existing sewer connection, which is to be used, shall be exposed at the property line by the contractor and the Environmental Services Department is to be called to rod the lateral to the main sewer and approve of its use before the connection is completed from the street line to the building.

- (c) Existing sewer connections, which are not to be used, shall be capped off with a mechanical cap at the property line to prevent infiltration into the main sewer.
- (d) The reinstatement of sidewalks, concrete curbs and gutters, and landscaping on the public road allowance is to be done by the Owner at the Owner's expense, unless otherwise directed by the City's General Manager of Transportation & Operations Services.
- The reinstatement of asphalt roadways on the City road allowance is to be done by the City of Belleville at the Owner's expense, unless otherwise directed by the City's General Manager of Transportation & Operations Services.
- (e) Existing driveways, which are not to be used, are to be removed. Any curb cuts, which are to be replaced, are to be constructed of full height curb and gutter to City standards.
- (f) Existing subdrains along the curb, which are disturbed, are to be restored to their original condition.
- (g) Any work done on the Quinte Conservation property shall be carried out to their satisfaction and contact should be made with them to arrange inspections. (A copy of the Conservation requirements and approval is to be provided to the City.)
- (h) The top of curbs abutting City sidewalks shall be kept level with the sidewalks for a distance of 0.3 metres from the sidewalk.
- (i) All trees, shrubs and other landscaping features, both existing and proposed, are to be kept a minimum of 1 metre clear of the centreline of swales.
- (j) The Owner and/or Contractor is required to obtain a 'Road Cut Permit' from Transportation & Operations Services before commencing any work on the City road allowance.
- (k) The new driveway shall be constructed so that it does not block the drainage in the ditch or along the edge of the road.
- (l) Before a culvert is installed and/or extended in a driveway within the City road allowance, the Owner will sign a City work order for the installation of the proposed culvert by the City and pay the full cost to the City unless otherwise directed by the City's General Manager of Transportation & Operations Services.
- OR if a cleanout needed
- (m) Before a culvert is installed and/or extended in a driveway, the Owner will sign a City work order for the installation by the City and pay the full cost to the City unless otherwise directed by the City's General Manager of Transportation & Operations Services.
- (n) The depth of cover over the proposed sanitary building sewer should be checked. Wherever the cover over a sanitary sewer is 1.5 metres or less, it is to be insulated with 100mm thick x 1.2m wide insulation placed in two (2) layers with staggered joints, and to be Styrofoam Brand H.I. Type IV.
- (o) Rebuild existing maintenance holes within the City road allowance as directed by the City's General Manager of Environmental Services.
- (p) Storm and sanitary sewer mains on City road allowances are to be field tested after construction in accordance with OPSS 410 and the method of testing shall be approved by the City.

NOTES TO BE SHOWN ON SITE PLAN DRAWINGS RELATED TO OFFSITE WATER SYSTEM: (road allowance)

1. Notwithstanding the following General Notes, all watermain pipe and fittings, valves, hydrants, water services and all other appurtenances are to be installed in accordance with their respective specification in the current City of Belleville Manual of Standard Specifications.
2. These notes are intended to summarize the City's requirements. However, the Contractor is to consult the respective City standard specifications for further detail and not rely solely on these notes.
3. Unless specified otherwise, all references to City of Belleville standard specifications, standard drawings or industry standards refer to the latest edition.
4. Water service materials, including pipes, fittings, valves and connections, are to be as specified in City of Belleville Standard Specification No. SS-WD-1140.

5. The cover for all water services is to be a minimum of 1.8 metres at all locations along the service including the bottom of ditches.
6. Where a water service crosses over or under a sanitary sewer or storm sewer (including laterals and catch basin leads), a minimum clear separation of 0.5 metres must be maintained, measured from pipe wall to pipe wall.
7. Where a water service crosses over or under other utilities, 0.30 metres clearance shall be provided, provided proper bedding can be maintained.
8. No water service pipe shall have a capacity that is less than the peak demand flow.
9. The interruption of the water supply to customers shall only be effected in accordance with City of Belleville Standard Specification SS-WD-1030.
10. Any existing water services to the site that are not required are to be disconnected at the main in accordance with the requirements of the City of Belleville at the Owner's expense.
11. The Contractor shall submit all required shop drawings and other submittals in accordance with the respective City of Belleville Standard Specification prior to commencing construction.

The following notes are to be included for OFFSITE WATER WORKS, as required, depending on the size of the pipe to be constructed for the site. Both sets of notes may be required if both small and large pipes will be used on the private lands, to service the site. (road allowance)

Water Services 50mm in Diameter or Less

12. Water services are to be a minimum diameter of 19mm.
13. The minimum horizontal clear separation between the water service and any sewer lateral is 0.6 metres, measured from pipe wall to pipe wall.
14. Curb stops are to be located on the City road allowance 150mm from the property line.
15. Curb stops are to be located away from driveways, poles, transformers, secondary pedestals, maintenance holes and any other aboveground appurtenances in accordance with City of Belleville Standard Specification No. SS-WD-1140.

Water Services Greater than 50mm in Diameter

16. All new water service installations shall be inspected, tested and commissioned in accordance with City of Belleville Standard Specification No. SS-WD-1190.
17. The minimum horizontal clear separation between the water service and any sewer lateral is 2.5 metres, measured from pipe wall to pipe wall.
18. Joint restraints are to be provided in accordance with City of Belleville Standard Specification No. SS-WD-1140.
19. A flow control valve is to be located on the City road allowance 150mm from the property line.
20. Flow control valves are to be located in driveways or parking lots.
21. Typically, the maximum cover over the water service at the flow control valve is to be 2.5 metres.
22. Where a watermain crosses within 1.5 metres of a catch basin the watermain is to be protected in accordance with City of Belleville Standard Drawing No. SD-WD-1031.
23. Hydrants to be located away from driveways, poles, transformers, secondary pedestals, maintenance holes and any other aboveground appurtenances in accordance with City of Belleville Standard Specification No. SS-WD-1130.
24. Hydrants to be connected to the water service as specified in City of Belleville Standard Specification No. SS-WD-1130 and Standard Drawing No. SD-WD-1101.

The following Ontario Provincial Specifications will be used. The Contractor is responsible for obtaining current copies of these standards.

OPSS Municipal

100	MUNI General Conditions of Contract
180	Management of Excess Materials
206	Grading
310	Hot Mix Asphalt
314	Untreated Granular Subbase, Base, Surface, Shoulder, and Stockpiling
401	Trenching, Backfilling, and Compacting
402	Excavating, Backfilling, and Compacting for Maintenance Holes, Catch Basins, Ditch Inlets, and Valve Chambers
403	Rock Excavation for Pipelines, Utilities, and Associated Structures in Open Cut
407	Maintenance Hole, Catch Basin, Ditch Inlet, and Valve Chamber Installation
408	Adjusting or Rebuilding Maintenance Holes, Catch Basins, Ditch Inlets, and Valve Chambers
409	Closed-Circuit Television (CCTV) Inspection of Pipelines
410	Pipe Sewer Installation in Open Cut
501	Compacting
510	Removal
1001	Aggregates - General
1003	Aggregates - Hot Mix Asphalt
1010	Aggregates - Base, Subbase, Select Subgrade, and Backfill Material
1150	Hot Mix Asphalt (HMA)
1841	Non-Pressure Polyvinyl Chloride (PVC) Pipe Products
1850	Frames, Grates, Covers, and Gratings
1853	Rubber Adjustment Units for Maintenance Holes, Catch Basins, and Valve Chambers

OPSS Provincial

308 Tack Coating and Joint Painting

OPSD

401.010	Cast Iron, Square Frame with Circular Closed or Open Cover for Maintenance Holes
701.010	Precast Concrete Maintenance Hole, 1200 mm Diameter
701.030	Precast Concrete Maintenance Hole Components, 1200 mm Diameter, Tapered Top and Flat Cap
701.031	Precast Concrete Maintenance Hole Components, 1200 mm Diameter, Riser and Monolithic Base
701.032	Precast Concrete Maintenance Hole Components, 1200 mm Diameter, Base Slab

General Notes

1. The approval of this plan does not exempt the owner's contractor from obtaining, but not limited to, the following permits, road cut, encroachment, etc.
2. The Contractor shall be responsible for all traffic control and safety measures as per OPSS and the Ontario Traffic Manual Book 7 during the construction period, including the supply, installation, and removal of all necessary signage, delineators, and barriers.
3. All construction work is to be carried out in accordance with the Occupational Health and Safety Act and regulations for construction projects.
4. All saw cutting required and the fine grading prior to paving are to be included.

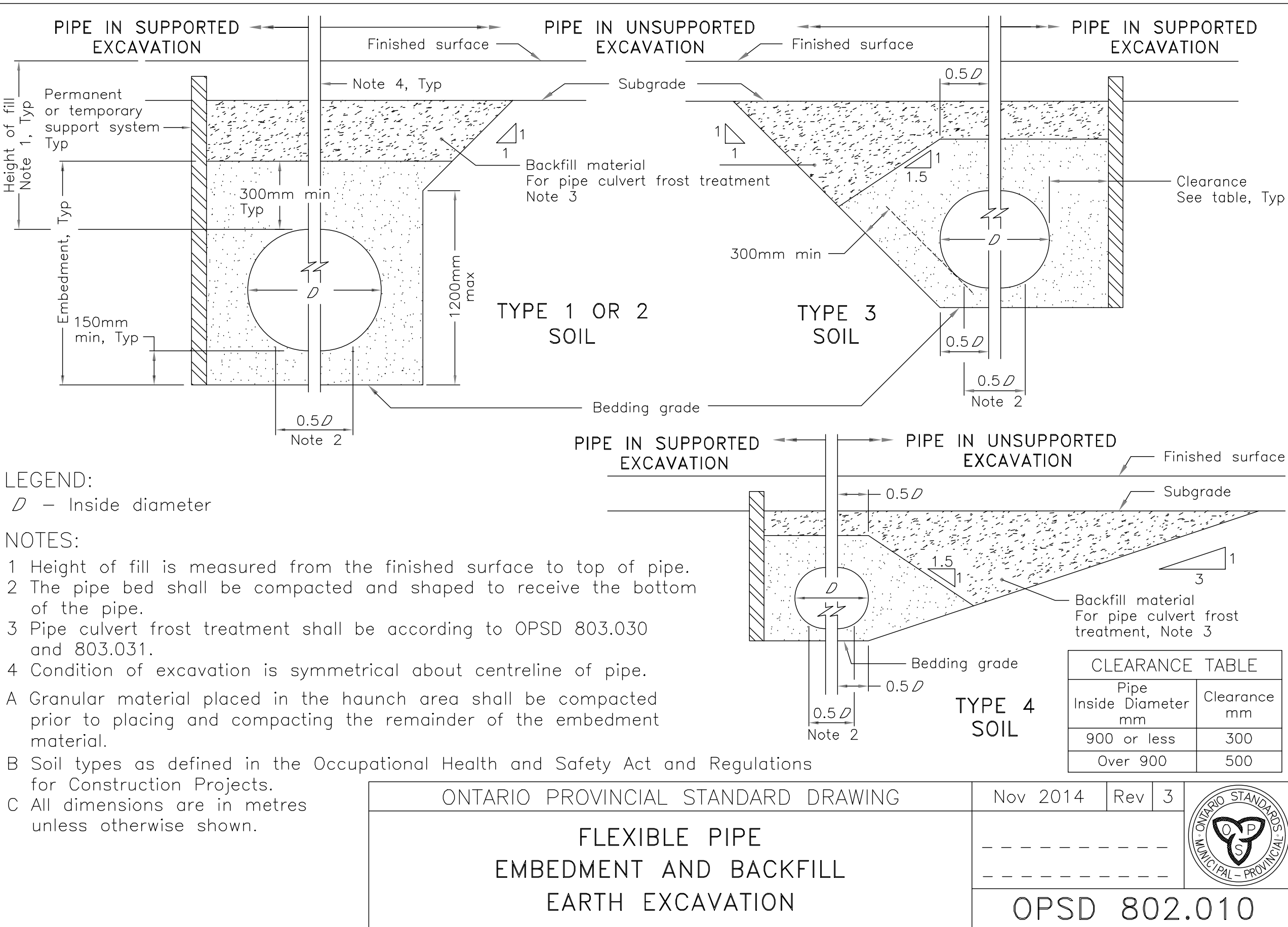

GENERAL NOTES:
- ALL INFORMATION TO BE VERIFIED ON SITE PRIOR TO COMMENCING ANY WORK. ANY DISCREPANCIES ARE TO BE REPORTED TO THE CONSULTANT IMMEDIATELY.
- ALL UTILITY LOCATIONS SHOWN ON THE DRAWINGS ARE APPROXIMATE. THE CONTRACTOR SHALL CONFIRM THE LOCATION ON SITE AND ASSUME ALL LIABILITY FOR DAMAGE TO ALL UTILITIES.
- EXCLUDING THE BENCHMARK AND DESCRIPTION PROVIDED FOR THIS PROJECT, NO OTHER ELEVATIONS ARE TO BE USED AS A REFERENCE ELEVATION FOR ANY PURPOSE.

METRIC NOTE:

- ALL DIMENSIONS SHOWN ARE IN METRES OR MILLIMETRES, UNLESS OTHERWISE NOTED.

GEOMETRIC NOTE:

- ALL SURVEY DATA SHOWN ON THIS DRAWING WAS RECORDED USING REAL-TIME KINETIC (RTK) GPS OBSERVATIONS IN REFERENCE TO UTM 18 NORTH COORDINATE SYSTEM.
- ALL ELEVATIONS ARE IN REFERENCE TO LOCAL DATUM MADS - GEODETIC MODEL HTZ.0, UNLESS DESCRIBED OTHERWISE.

** DRAWINGS ARE NOT TO BE SCALED **

REVISIONS			
NO.	DATE	DESCRIPTION	BY
1	04/06/2025	ISSUED FOR REVIEW	DFM
2	31/07/2025	ISSUED FOR PERMIT	DFM

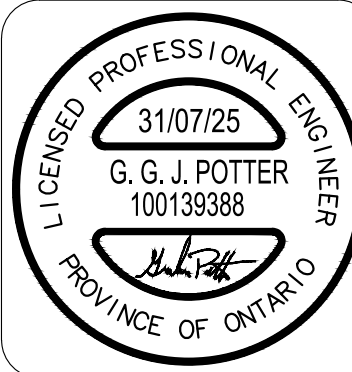

HASTINGS PRINCE EDWARD
COUNTY DISTRICT
SCHOOL BOARD
EAST HILL ELEMENTARY SCHOOL

NOTES AND DETAILS

DRAWN BY: JH/DFM	PROJECT NO: 230-5445
DESIGNED BY: AMR	DATE: July 2025
CHECKED BY: AMR/GP	SCALE: HORIZONTAL - N/A VERTICAL - N/A
APPROVED BY: AMR/GP	CONTRACT NO: DRAWING NO: DE-1